

Architecting the Enterprise for Geo-Friction

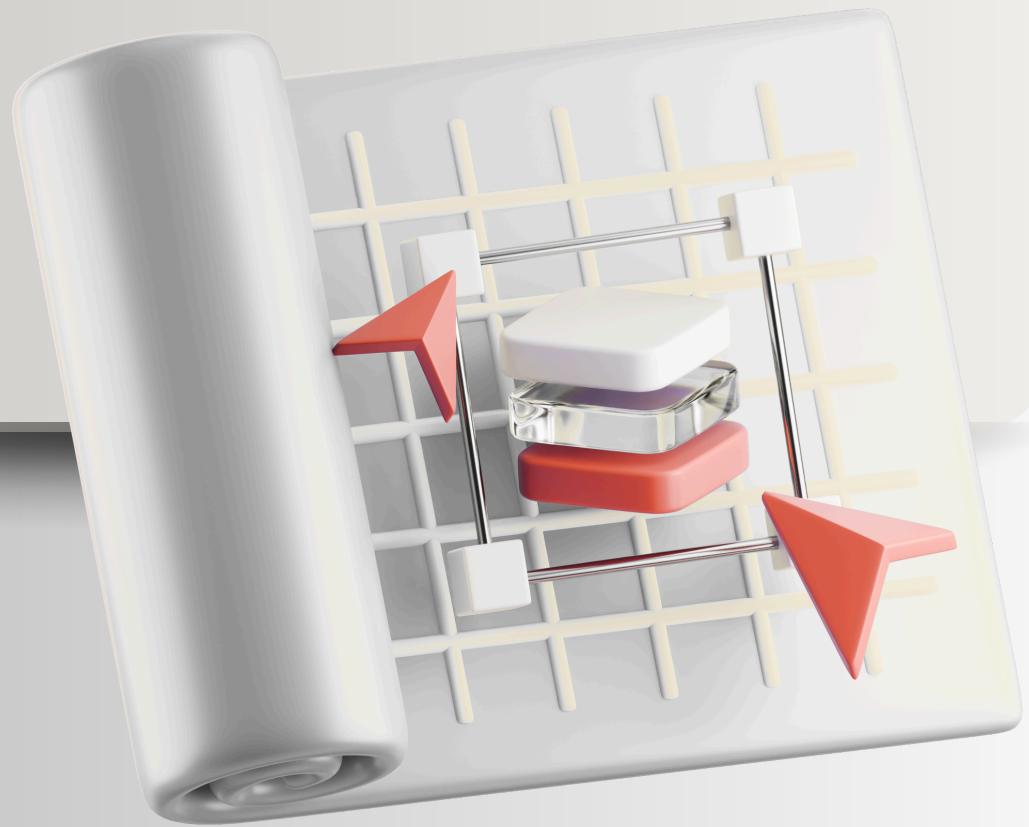

Moving beyond episodic recovery to
structural redesign. ▶▶



Friction is a Condition, Not an Event

DEFINITION

Geo-friction is not a single event or shock. It is the **persistent, operationally corrosive force** of geopolitical risk that changes the cost, speed, and certainty of doing business.

Matrix ×	 The Shock <i>An event you recover from</i> ×	 The Friction <i>A condition you operate within</i> ×
NATURE	Low-frequency, episodic scenarios (e.g., border closures, facility loss).	Operationally corrosive, recurrent constraints.
IMPACT	Stops business entirely. Arrives with clear boundaries.	Changes the cost, speed, and certainty of doing business.
POSTURE	Recover capabilities; an event you recover from.	Keep operating under constraint; a condition you must operate within.

The Shift to Partial Constraint

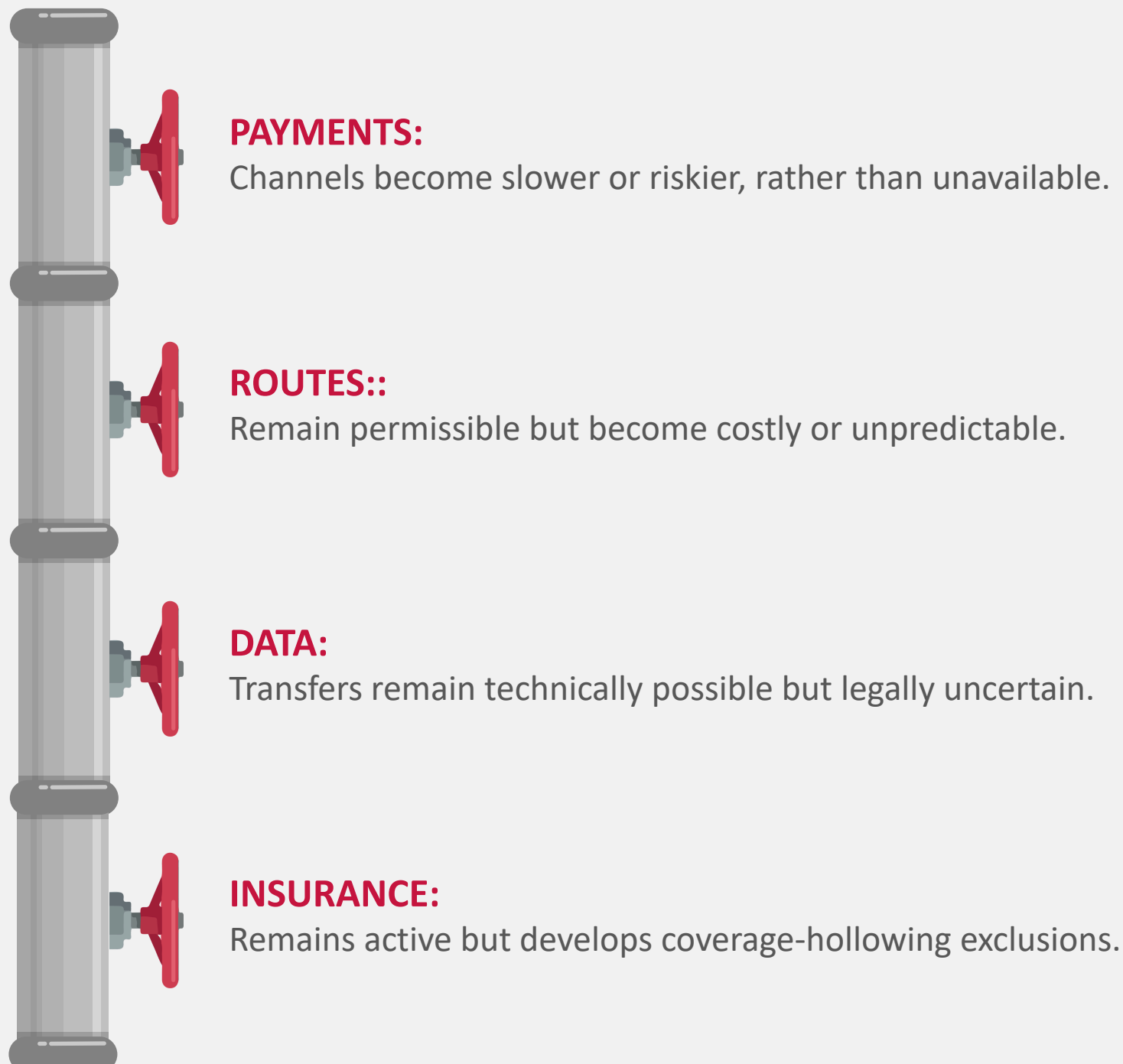

i KEY INSIGHT:

Geo-friction removes normal levers—clarity, stable permissions, predictable enforcement—then asks the organization to perform anyway.

Operating Safely Inside Constraint

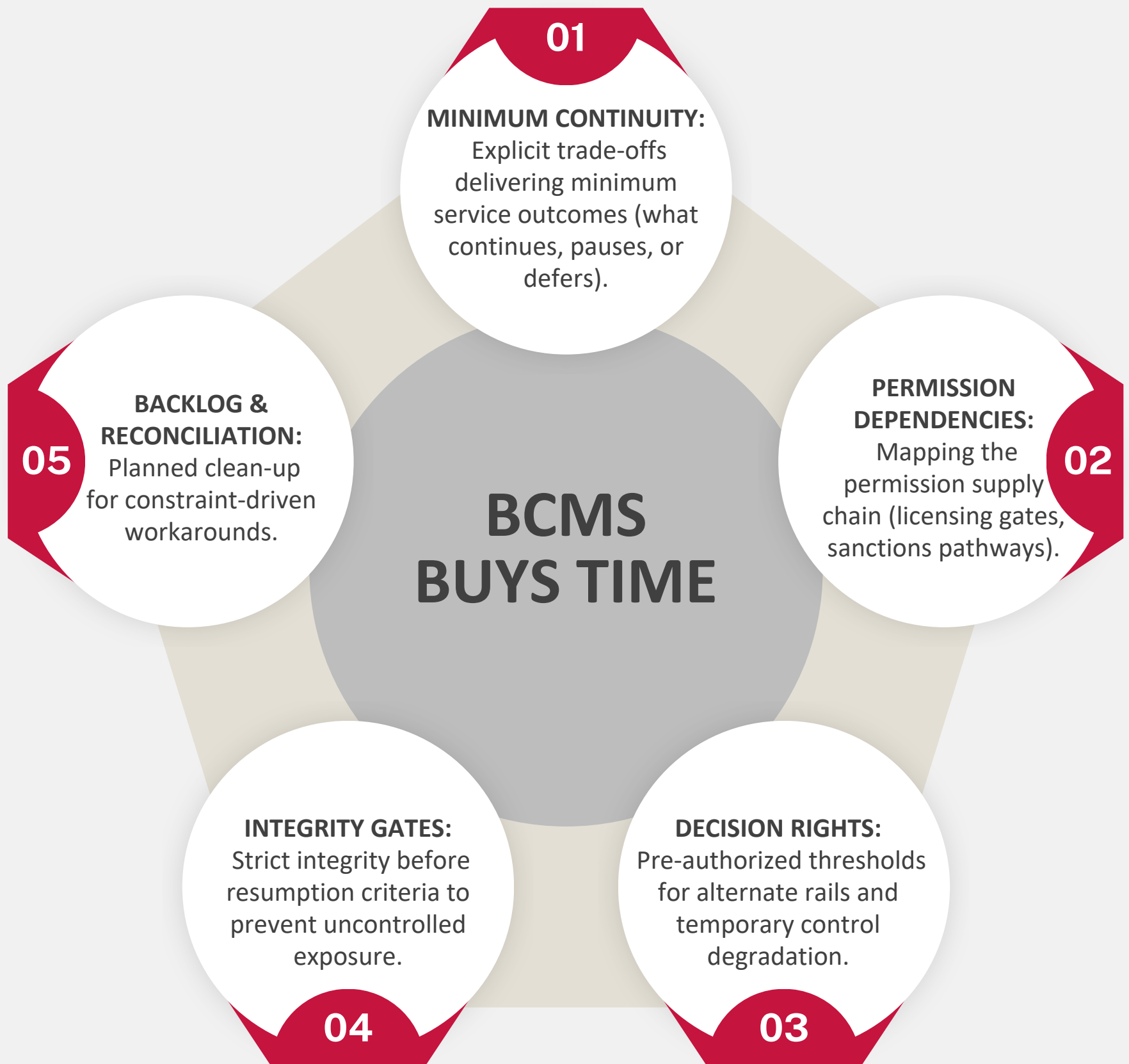

The Normalization of the Workaround

The Downward Spiral Model

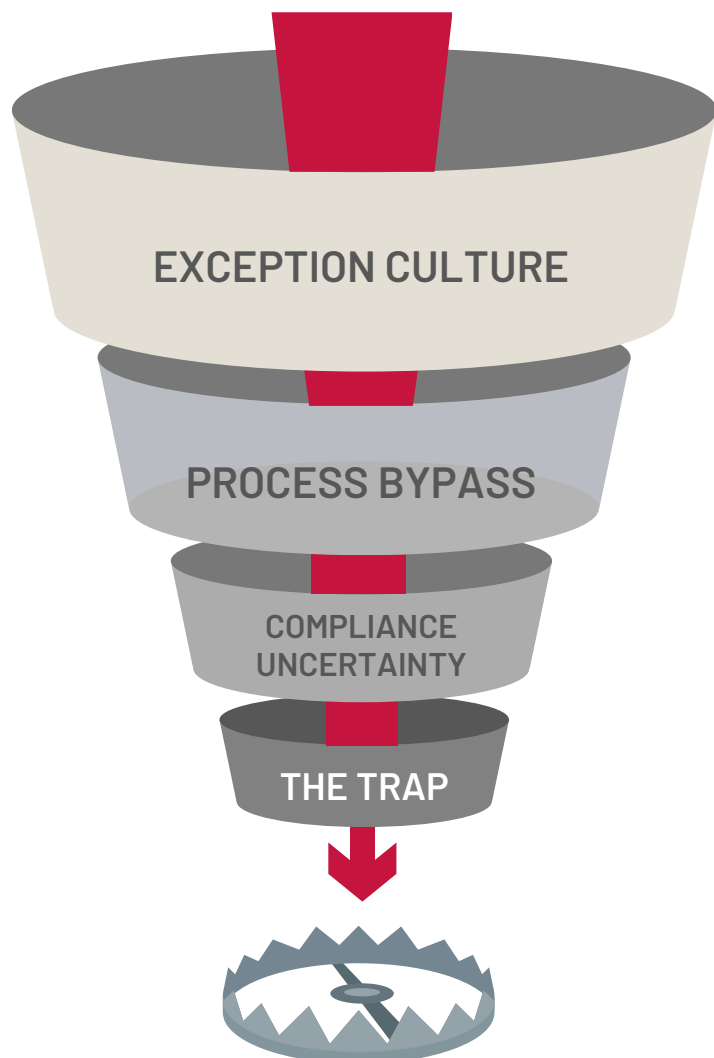

Exception Culture

Constant exceptions & informal vendor substitutions.

Process Bypass

Perpetual rerouting & repeated payment improvisation.

Compliance Uncertainty

Recurring compliance ambiguity resolved case-by-case.

The Trap

What feels like resilience is actually Strategic Drift.

RESULTING DAMAGE



Eroded reliability



Expanded operating risk



Hidden economic leakage that no single incident report captures

Establishing the Boundary Between Survival and Redesign

CONTINUITY (BCMS) VS STRATEGIC REDESIGN



Redesigning for Freedom of Movement

The Optionality Spectrum



Supplier Portfolio Architecture:

Contracts designed for substitution without renegotiation.



Footprint Diversification:

Jurisdictional resilience, not just geographic dispersion.



Payment-Rail Resilience:

Alternate settlement pathways for critical flows.

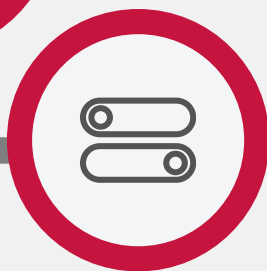

Customer Promise Redesign:

Updating lead times, SLAs, and pricing to reflect constraint realities.



Platform & Data Posture:

The ability to relocate, segment, or localize without re-engineering.

KEY INSIGHT:

The strategic lens is not “avoid cost,” but rather pricing the optionality premium—the deliberate investment required to preserve choice.

Designing the Handshake

The Handshake Equation

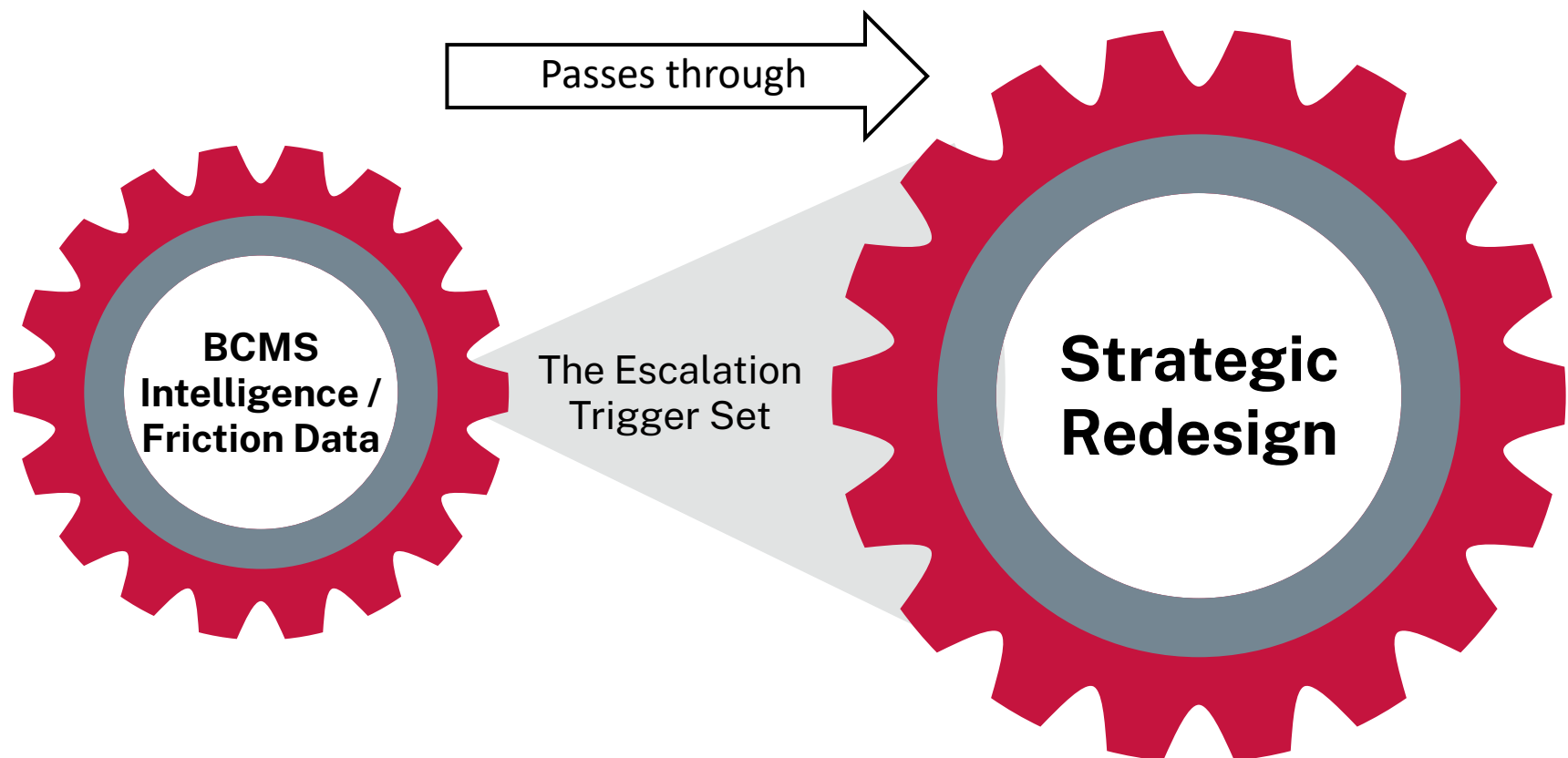

i CORE MESSAGE:

Mature organizations do not allow this interface to emerge through repeated improvisation. They deliberately design the conversion layer where time is converted into freedom.

Defining the Thresholds for Redesign

The Trigger Dashboard (Operational)

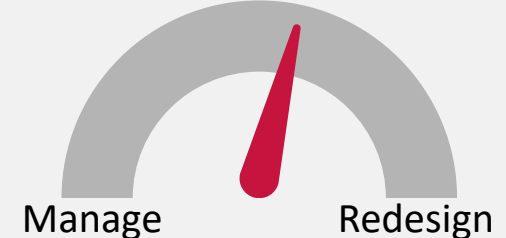
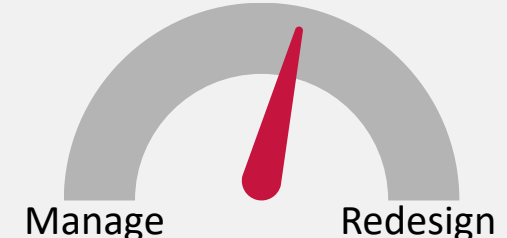
TRIGGER 1	TRIGGER 2	TRIGGER 3
 <p>Manage Redesign</p>	 <p>Manage Redesign</p>	 <p>Manage Redesign</p>
<p>FREQUENCY</p> <p>THRESHOLD: The same constraint forces continuity mode >2 times in a quarter.</p> <p>ACTION: Elevate to strategic redesign item.</p>	<p>MARGIN</p> <p>THRESHOLD: Workaround costs exceed defined viability threshold.</p> <p>ACTION: Continuity stops being economically viable.</p>	<p>PROMISE</p> <p>THRESHOLD: Customer commitments require repeated exceptions.</p> <p>ACTION: The customer promise itself must be strategically redesigned.</p>

Escalating Systemic Operational Limits

The Trigger Dashboard (Systemic)

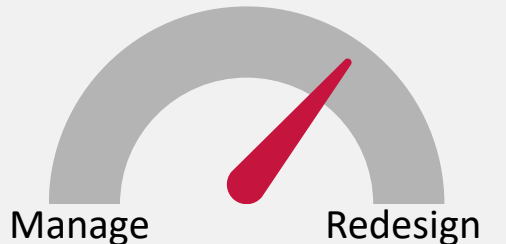
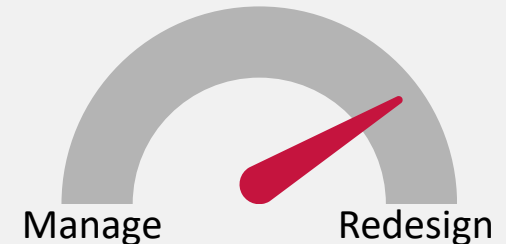
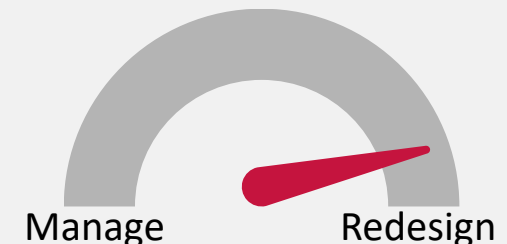
TRIGGER 4	TRIGGER 5	TRIGGER 6
 <p>Manage Redesign</p>	 <p>Manage Redesign</p>	 <p>Manage Redesign</p>
<p>PERMISSION</p> <p>THRESHOLD: Licensing, sanctions screening, or insurance exclusions become chronic bottlenecks.</p> <p>ACTION: Re-architect the permission supply chain.</p>	<p>INTEGRITY</p> <p>THRESHOLD: Integrity gates (data controls, settlement methods) cannot be met reliably.</p> <p>ACTION: The fundamental operating model and transaction classes must change.</p>	<p>LATENCY</p> <p>THRESHOLD: Time-to-decision repeatedly exceeds tolerance.</p> <p>ACTION: Redesign authority structures, as decision congestion becomes the outage.</p>

The Execution Horizon: Timeline to Compliance

The Architecture of Resilience

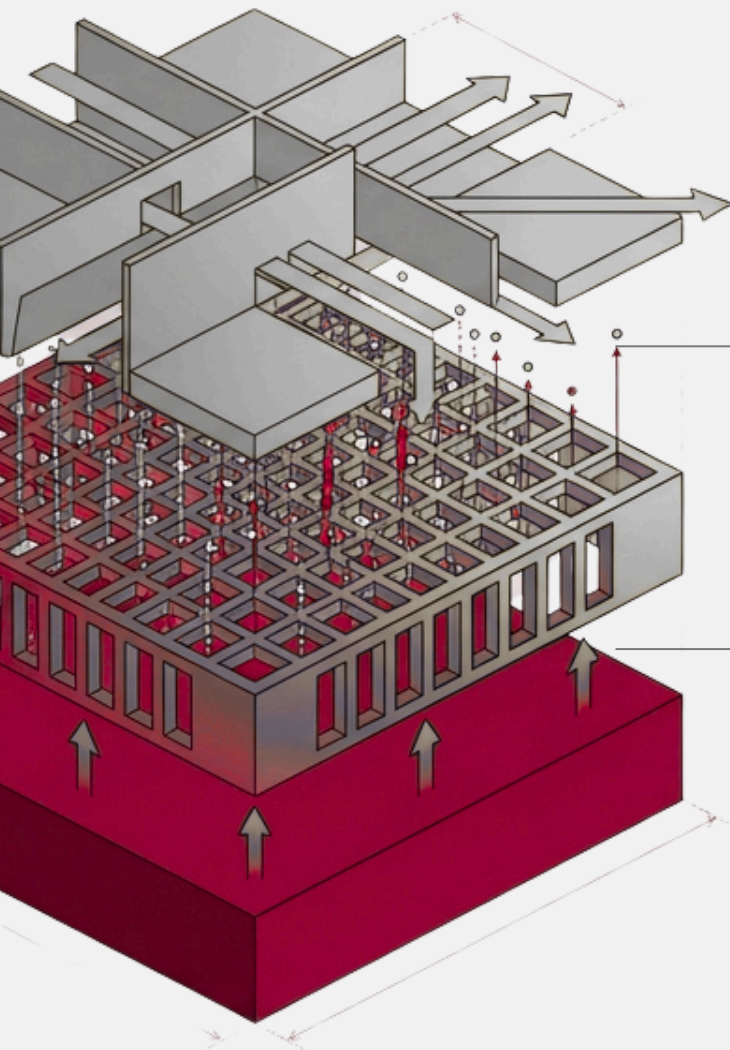

STRATEGY ENGINE (Generating Optionality)

GOVERNABILITY IS SHARED:

Geo-friction is a condition to be designed for. Organizations that master this handshake systematically harvest friction data to architect a permanent advantage. They remain fundamentally governable.

ESCALATION TRIGGERS (Harvesting Data)

OPTIONALITY IS STRATEGIC:

Strategy restores freedom of movement through structural design, preventing indefinite reliance on workarounds.

BCMS SHIELD (Protecting Operations)

RESILIENCE IS OPERATIONAL:

BCMS is indispensable for keeping the enterprise functioning when constraints tighten.



DESIGNING ENTERPRISES FOR A WORLD OF GEO-FRICTION

Move beyond episodic recovery and
build structural resilience that enables
long-term strategic freedom.



FOR A WORKING SESSION
CONTACT US AT

mcagrc@mcagulf.com